

ARK 自由安装气缸

Free Mount Air Cylinder

Series KCU (Ø6~Ø32)

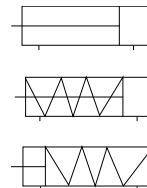

规格 Specifications

缸径	Bore(mm)	6	10	16	20	25	32
使用流体	Fluid	洁净空气 Clean Air					
动作形式	Action	双动,单动(弹簧压回,弹簧压出) Double Acting, Single Acting(Spring Return/Extend)					
保证耐压力	Proof Pressure (MPa)	1.5					
最高使用压力	Max. Pressure (MPa)	1.0					
环境及流体温度	Ambient Temperature	-5~60°C (未冻结 No Freezing)					
缓冲	Cushion	橡胶缓冲 Rubber					
行程公差	Stroke Tolerance	+1.0 0					
* 润滑	Lubrication	不需要 Non-Lube					
接管口径	Port Size Rc(PT)	M5×0.8					1/8"

* 若需要润滑请用透平1号油ISOVG32
Use Turbine Oil 1st-grade ISOVG32, if necessary.

行程/磁性开关选择 Standard Stroke/Auto Switch

缸径 Bore(mm)	标准行程 Standard Stroke (mm)		轨道安装型 Rail Mounting
	双动 Double	单动 Single	
6	5,10,15,20,25,30,35	5,10,15,20	D-A90K□
10			
16	5,10,15,20,25,30,40,50		
20	5,10,15,20,25,30, 40,50,60		
25			
32			

3

型号表示方法 How To Order

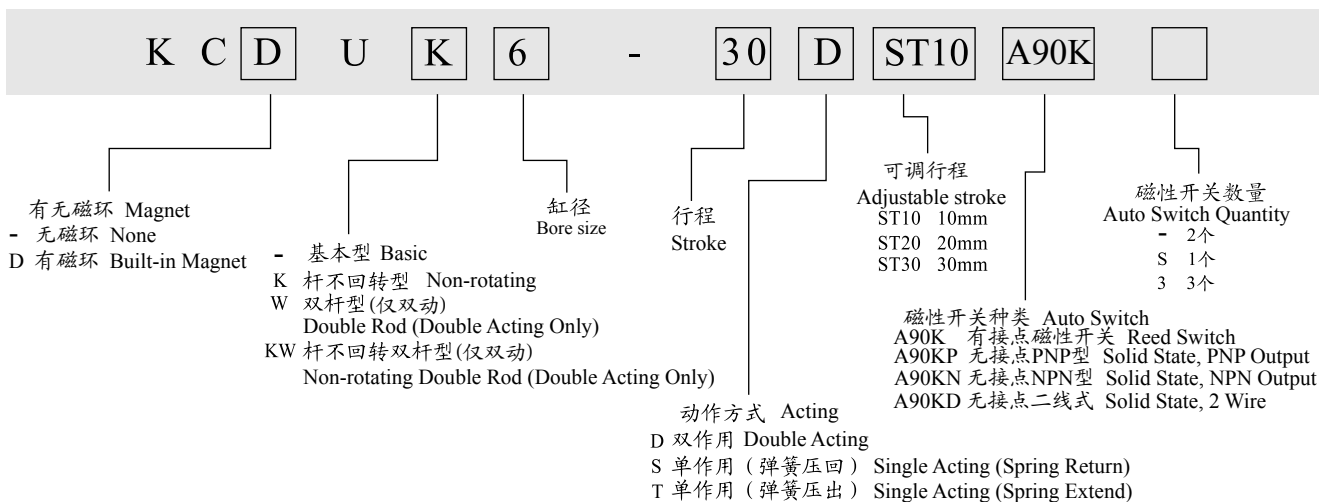

自由安装气缸 Free Mount Air Cylinder

Series KCU

外形尺寸图 Dimensions (mm)

KCU-D 基本-双作用型 (Basic Type - Double Acting)

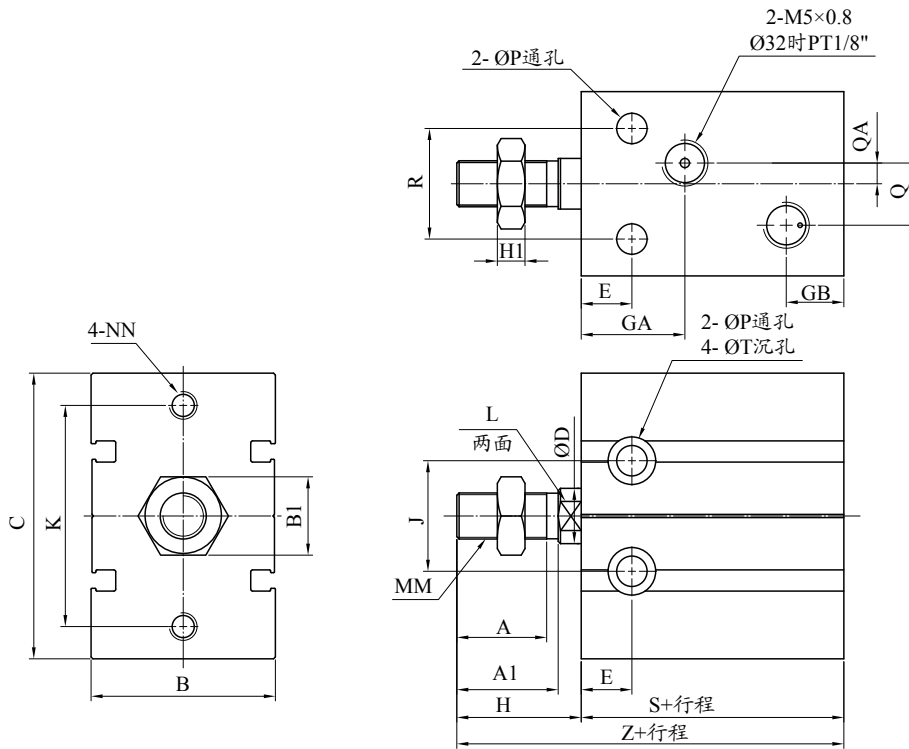

符号 缸径	A	A1	B	B1	C	D	E	GA	GB	H	H1	J	K	L
6	7	8	16.5	5.5	22	3	7	14	10	13	2.4	10	17	-
10	10	11	16.5	7	24	4	7	15.5	10	16	2.4	11	18	-
16	11	12.5	20	8	32	6	7	14.5	10	16	4	14	25	5
20	12	14	26	10	40	8	9	19	11	19	5	16	30	6
25	15.5	18	32	12	50	10	10	21.5	8.5	23	6	20	38	8
32	19.5	22	40	17	62	12	11	23	12.5	27	6	24	48	10

MM	NN	P	Q	QA	R	T	无磁环		带磁环	
							S	Z	S	Z
M3×0.5	M3×0.5 深5	3.2	-	-	7	6 深5	33	46	33	46
M4×0.7	M3×0.5 深5	3.2	-	-	9	6 深5.6	36	52	36	52
M5×0.8	M4×0.7 深5	4.5	3	1.5	12	7.6 深6.5	30	46	40	56
M6×1.0	M5×0.8 深7.5	5.5	9	4.5	16	9.3 深8	36	55	46	65
M8×1.25	M5×0.8 深8	5.5	12	6	20	9.3 深9	40	63	50	73
M10×1.25	M6×1.0 深9	6.6	13	4.5	24	11 深11.5	42	69	52	79

自由安装气缸 Free Mount Air Cylinder

Series KCU

外形尺寸图 Dimensions (mm)

KCU-S 基本-单作用 (弹簧压回)
Basic Type - Single Acting (Spring Return)

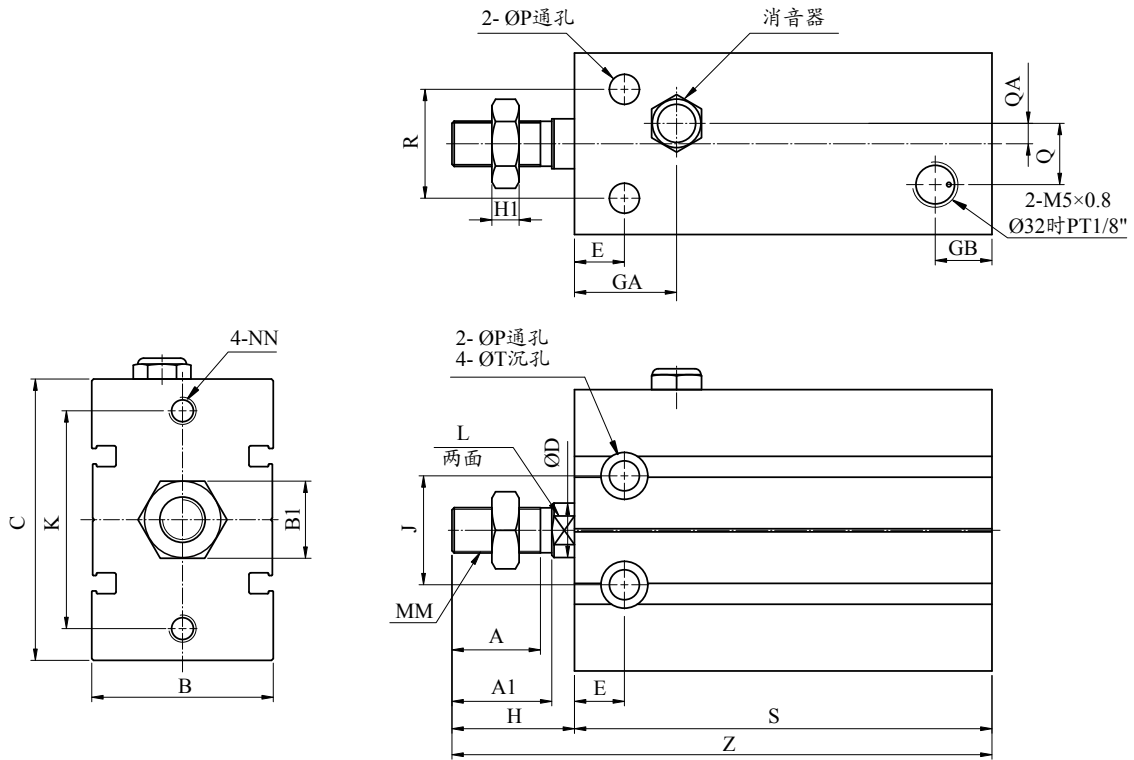

符号 缸径	A	A1	B	B1	C	D	E	GA	GB	H	H1	J	K	L
6	7	8	16.5	5.5	22	3	7	14	10	13	2.4	10	17	-
10	10	11	16.5	7	24	4	7	15.5	10	16	2.4	11	18	-
16	11	12.5	20	8	32	6	7	14.5	10	16	4	14	25	5
20	12	14	26	10	40	8	9	19	11	19	5	16	30	6
25	15.5	18	32	12	50	10	10	21.5	8.5	23	6	20	38	8
32	19.5	22	40	17	62	12	11	23	12.5	27	6	24	48	10

MM	NN	P	Q	QA	R	T	无磁环								带磁环							
							S				Z				S				Z			
							5St	10st	15st	20st	5St	10st	15st	20st	5St	10st	15st	20st	5St	10st	15st	20st
M3×0.5	M3×0.5 深5	3.2	-	-	7	6 深5	43	48	58	63	56	61	71	76	43	48	58	63	56	61	71	76
M4×0.7	M3×0.5 深5	3.2	-	-	9	6 深5.6	46	51	61	66	62	67	77	82	46	51	61	66	62	67	77	82
M5×0.8	M4×0.7 深5	4.5	3	1.5	12	7.6 深6.5	45	50	65	70	61	66	81	86	55	60	75	80	71	76	91	96
M6×1.0	M5×0.8 深7.5	5.5	9	4.5	16	9.3 深8	51	56	71	76	70	75	90	95	61	66	81	86	80	85	100	105
M8×1.25	M5×0.8 深8	5.5	12	6	20	9.3 深9	55	60	75	80	78	83	98	103	65	70	85	90	88	93	108	113
M10×1.25	M6×1.0 深9	6.6	13	4.5	24	11 深11.5	57	62	77	82	84	89	104	109	67	72	87	92	94	99	114	119

自由安装气缸 Free Mount Air Cylinder

Series KCU

外形尺寸图 Dimensions (mm)

KCU-T 基本-单作用 (弹簧压出)
Basic Type - Single Acting (Spring Extend)

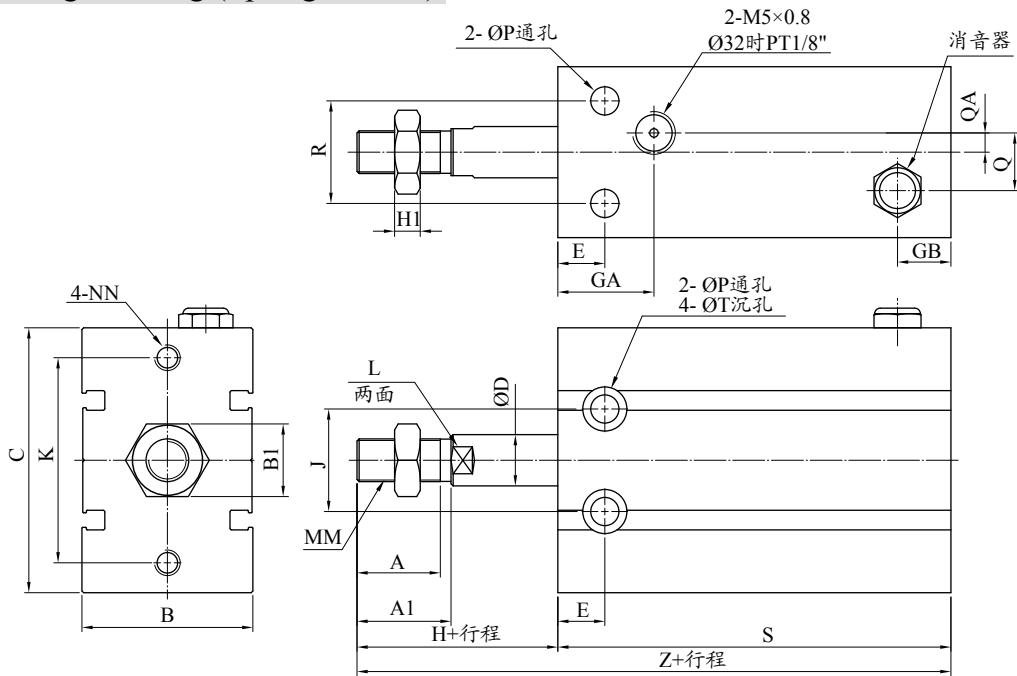

符号 缸径	A	A1	B	B1	C	D	E	GA	GB	H	H1	J	K	L	MM	NN	P	Q	QA	R	T
6	7	8	16.5	5.5	22	3	7	14	10	13	2.4	10	17	-	M3×0.5	M3×0.5深5	3.2	-	-	7	6深5
10	10	11	16.5	7	24	4	7	15.5	10	16	2.4	11	18	-	M4×0.7	M3×0.5深5	3.2	-	-	9	6深5.6
16	11	12.5	20	8	32	6	7	14.5	10	16	4	14	25	5	M5×0.8	M4×0.7深5	4.5	3	1.5	12	7.6深6.5
20	12	14	26	10	40	8	9	19	11	19	5	16	30	6	M6×1.0	M5×0.8深7.5	5.5	9	4.5	16	9.3深8
25	15.5	18	32	12	50	10	10	21.5	8.5	23	6	20	38	8	M8×1.25	M5×0.8深8	5.5	12	6	20	9.3深9
32	19.5	22	40	17	62	12	11	23	12.5	27	6	24	48	10	M10×1.25	M6×1.0深9	6.6	13	4.5	24	11深11.5

符号 缸径	无磁环								带磁环							
	S				Z				S				Z			
行程	5ST	10ST	15ST	20ST	5ST	10ST	15ST	20ST	5ST	10ST	15ST	20ST	5ST	10ST	15ST	20ST
6	43	48	58	63	56	61	71	76	43	48	58	63	56	61	71	76
10	46	51	61	66	62	67	77	82	46	51	61	66	62	67	77	82
16	45	50	65	70	61	66	81	86	55	60	75	80	71	76	91	96
20	51	56	71	76	70	75	90	95	61	66	81	86	80	85	100	105
25	55	60	75	80	78	83	98	103	65	70	85	90	88	93	108	113
32	57	62	77	82	84	89	104	109	67	72	87	92	94	99	114	119

自由安装气缸 Free Mount Air Cylinder

Series KCU

外形尺寸图 Dimensions (mm)

KCUW 双杆型 (Double Rod)

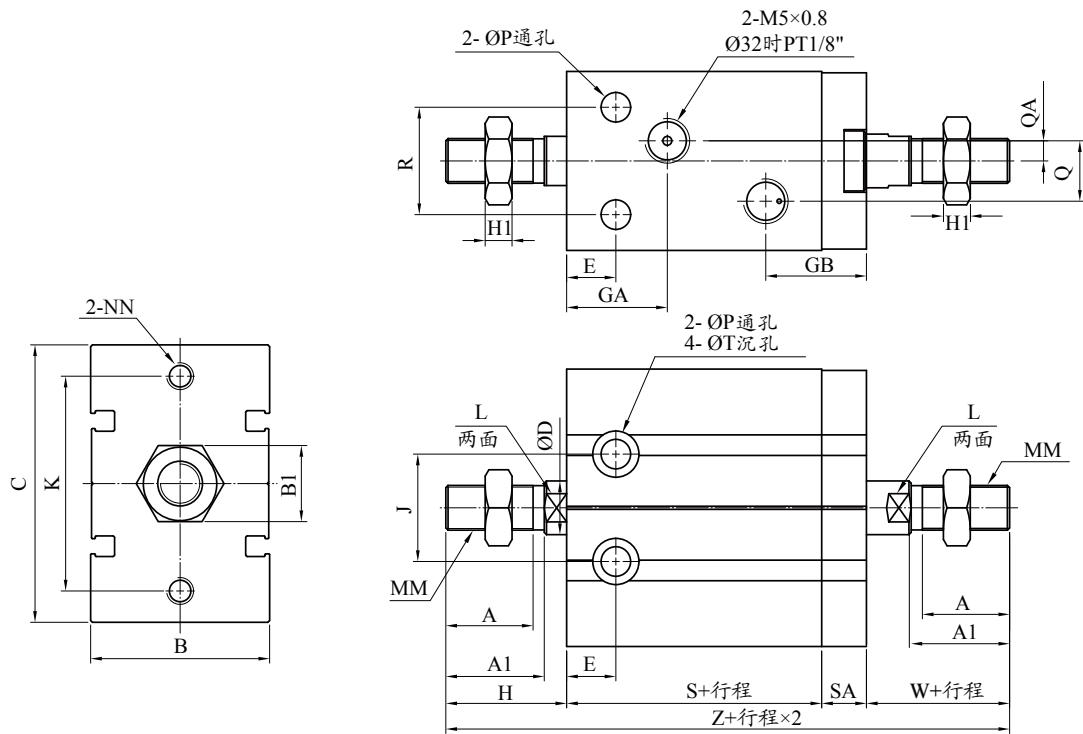

符号 缸径	A	A1	B	B1	C	D	E	GA	GB	H	H1	J	K	L
6	7	8	16.5	5.5	22	3	7	14	16	13	2.4	10	17	-
10	10	11	16.5	7	24	4	7	15.5	16	16	2.4	11	18	-
16	11	12.5	20	8	32	6	7	14.5	17.5	16	4	14	25	5
20	12	14	26	10	40	8	9	19	20	19	5	16	30	6
25	15.5	18	32	12	50	10	10	21.5	17.5	23	6	20	38	8
32	19.5	22	40	17	62	12	11	23	22.5	27	6	24	48	10

MM	NN	P	Q	QA	R	SA	T	W	无磁环		带磁环	
									S	Z	S	Z
M3×0.5	M3×0.5 深5	3.2	-	-	7	6	6 深5	13	38	70	38	70
M4×0.7	M3×0.5 深5	3.2	-	-	9	6	6 深5.6	16	36	74	36	74
M5×0.8	M4×0.7 深5	4.5	3	1.5	12	7.5	7.6 深6.5	16	30	69.5	40	79.5
M6×1.0	M5×0.8 深7.5	5.5	9	4.5	16	9	9.3 深8	19	36	83	46	93
M8×1.25	M5×0.8 深8	5.5	12	6	20	9	9.3 深9	23	40	95	50	105
M10×1.25	M6×1.0 深9	6.6	13	4.5	24	10	11 深11.5	27	42	106	52	116

自由安装气缸 Free Mount Air Cylinder

Series KCU

外形尺寸图 Dimensions (mm)

KCU-ST 基本型-可调行程
(Basic Type-Adjustable Stroke)

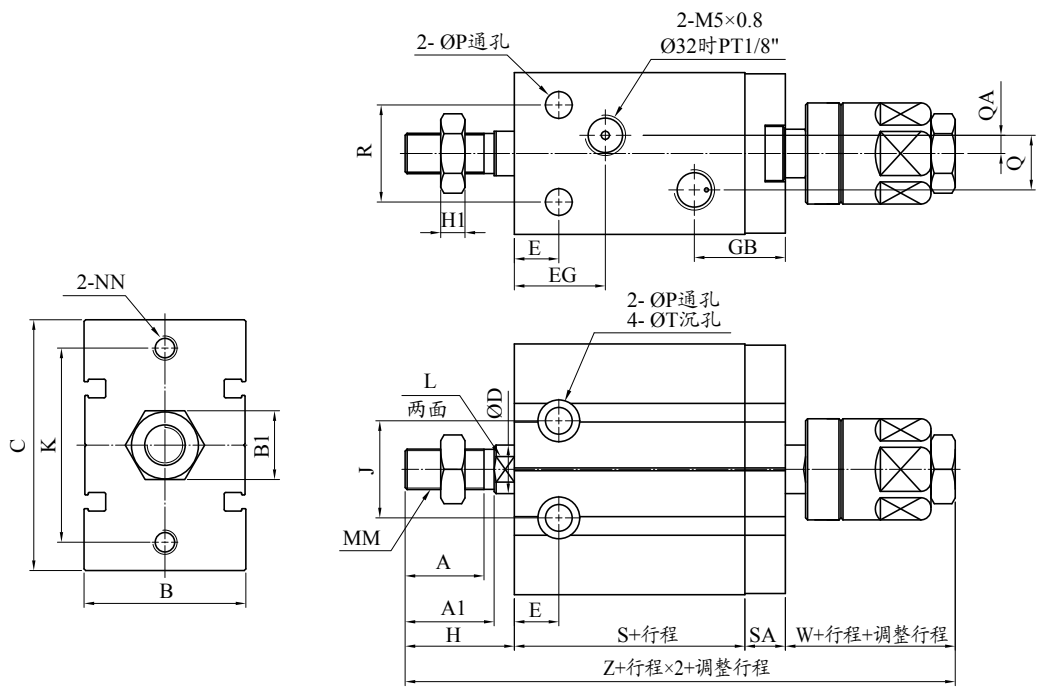

符号 缸径	A	A1	B	B1	C	D	E	GA	GB	H	H1	J	K	L
6	7	8	16.5	5.5	22	3	7	14	16	13	2.4	10	17	-
10	10	11	16.5	7	24	4	7	15.5	16	16	2.4	11	18	-
16	11	12.5	20	8	32	6	7	14.5	17.5	16	4	14	25	5
20	12	14	26	10	40	8	9	19	20	19	5	16	30	6
25	15.5	18	32	12	50	10	10	21.5	17.5	23	6	20	38	8
32	19.5	22	40	17	62	12	11	23	22.5	27	6	24	48	10

MM	NN	P	Q	QA	R	SA	T	W	无磁环		带磁环	
									S	Z	S	Z
M3×0.5	M3×0.5 深5	3.2	-	-	7	6	6 深5	13	38	70	38	70
M4×0.7	M3×0.5 深5	3.2	-	-	9	6	6 深5.6	14.7	36	72.7	36	72.7
M5×0.8	M4×0.7 深5	4.5	3	1.5	12	7.5	7.6 深6.5	17	30	70.5	40	80.5
M6×1.0	M5×0.8 深7.5	5.5	9	4.5	16	9	9.3 深8	21	36	85	46	95
M8×1.25	M5×0.8 深8	5.5	12	6	20	9	9.3 深9	25	40	97	50	107
M10×1.25	M6×1.0 深9	6.6	13	4.5	24	10	11 深11.5	27	42	106	52	116

自由安装气缸 Free Mount Air Cylinder

Series KCU

外形尺寸图 Dimensions (mm)

KCUK-D 杆不回转-双作用型
(Non-rotating Type - Double Acting)

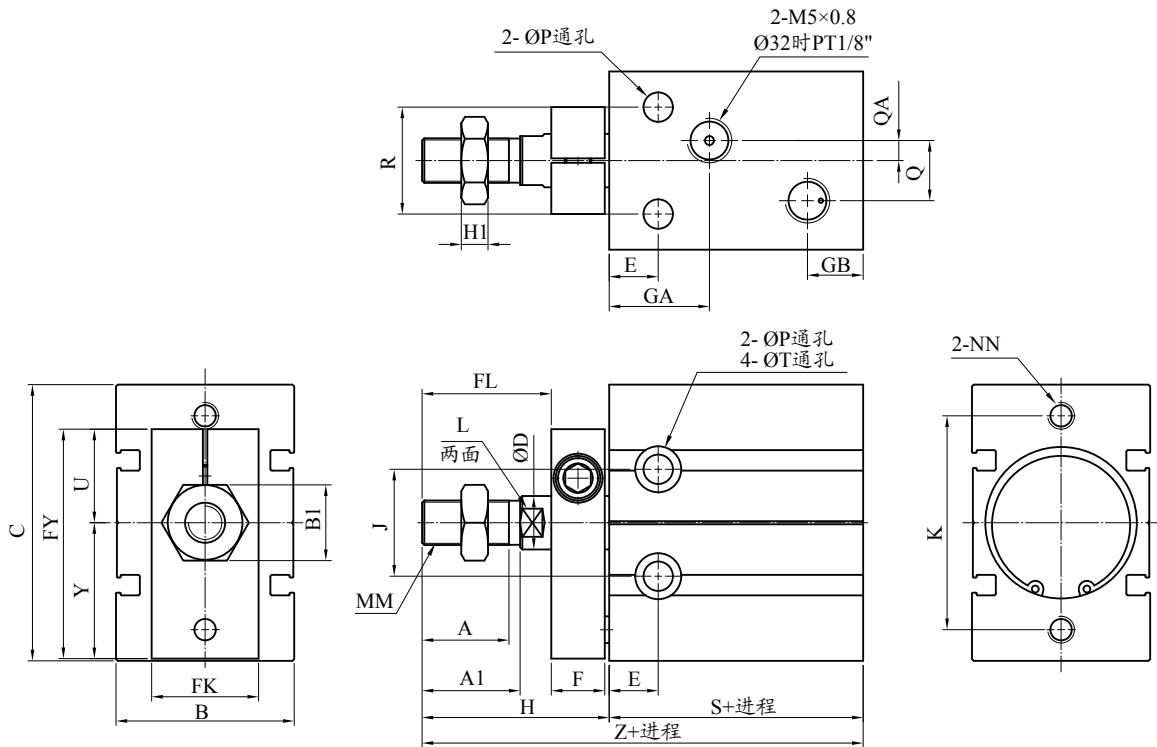

符号 缸径	A	A1	B	B1	C	D	E	F	FL	FK	FY	GA	GB	H	H1	J	K	L	Y
6	7	8	16.5	5.5	22	3	7	8	9	11	19	14	10	18	2.4	10	17	-	10.9
10	10	11	16.5	7	24	4	7	8	12	13	20.5	15.5	10	21	2.4	11	18	-	11.9
16	11	12.5	20	8	32	6	7	8	17	13	26.5	14.5	10	26	4	14	25	5	15.9
20	12	14	26	10	40	8	9	8	20	16	32	19	11	29	5	16	30	6	19.8
25	15.5	18	32	12	50	10	10	10	22	19	40	21.5	8.5	33	6	20	38	8	24.8
32	19.5	22	40	17	62	12	11	12	29	24	49	23	12.5	42	6	24	48	10	30.8

MM	NN	P	Q	QA	R	T	U	无磁环		带磁环	
								S	Z	S	Z
M3×0.5	M3×0.5 深5	3.2	-	-	7	6 深5	8.1	33	51	33	51
M4×0.7	M3×0.5 深5	3.2	-	-	9	6 深5.6	8.6	36	57	36	57
M5×0.8	M4×0.7 深5	4.5	3	1.5	12	7.6 深6.5	10.6	30	56	40	66
M6×1.0	M5×0.8 深7.5	5.5	9	4.5	16	9.3 深8	12.2	36	65	46	75
M8×1.25	M5×0.8 深8	5.5	12	6	20	9.3 深9	15.2	40	73	50	83
M10×1.25	M6×1.0 深9	6.6	13	4.5	24	11 深11.5	18.2	42	84	52	94

自由安装气缸 Free Mount Air Cylinder

Series KCU

外形尺寸图 Dimensions (mm)

KCUK-S 杆不回转型-单动 (弹簧压回)
 Non-rotating Type - Single Acting (Spring Return)

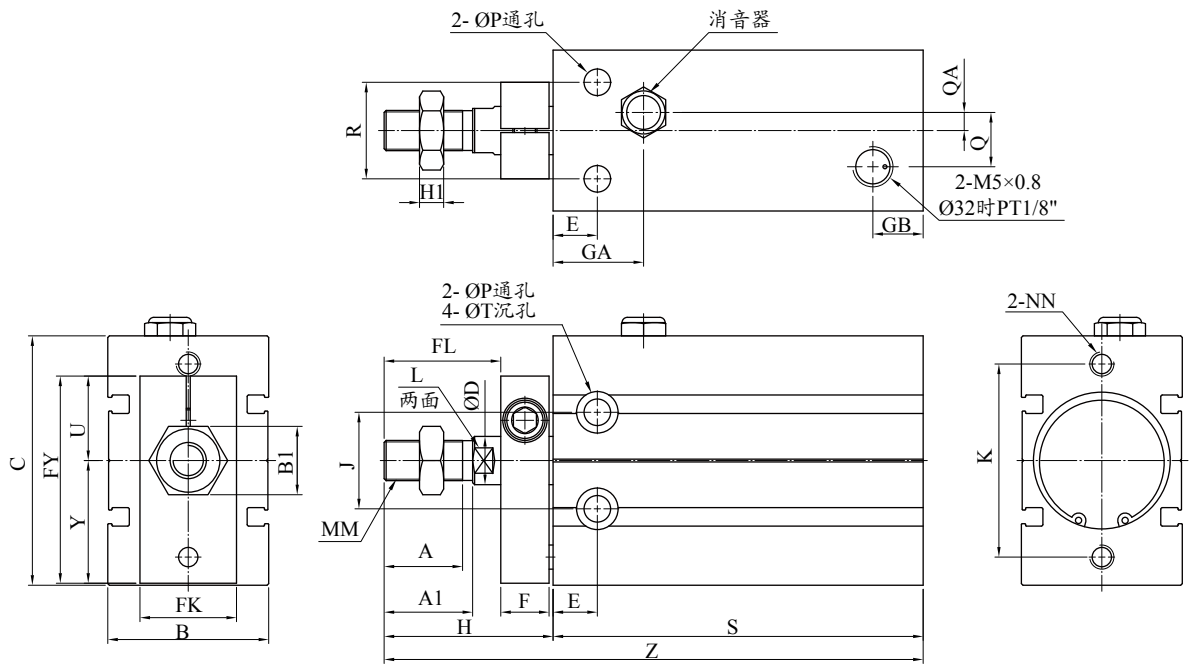

符号 缸径	A	A1	B	B1	C	D	E	F	FL	FK	FY	GA	GB	H	H1	J	K	L
6	7	8	16.5	5.5	22	3	7	8	9	11	19	14	10	18	2.4	10	17	-
10	10	11	16.5	7	24	4	7	8	12	13	20.5	15.5	10	21	2.4	11	18	-
16	11	12.5	20	8	32	6	7	8	17	13	26.5	14.5	10	26	4	14	25	5
20	12	14	26	10	40	8	9	8	20	16	32	19	11	29	5	16	30	6
25	15.5	18	32	12	50	10	10	10	22	19	40	21.5	8.5	33	6	20	38	8
32	19.5	22	40	17	62	12	11	12	29	24	49	23	12.5	42	6	24	48	10

MM	NN	P	Q	QA	R	U	Y	T	无磁环								带磁环							
									S				Z				S				Z			
									5St	10st	15st	20st	5St	10st	15st	20st	5St	10st	15st	20st	5St	10st	15st	20st
M3×0.5	M3×0.5深5	3.2	-	-	7	8.1	10.9	6深5	43	48	58	63	61	66	76	81	43	48	58	63	61	66	76	81
M4×0.7	M3×0.5深5	3.2	-	-	9	8.6	11.9	6深5.6	46	51	61	66	67	72	82	87	46	51	61	66	67	72	82	87
M5×0.8	M4×0.7深5	4.5	3	1.5	12	10.6	15.9	7.6深6.5	45	50	65	70	71	76	91	96	55	60	75	80	81	86	101	106
M6×1.0	M5×0.8深7.5	5.5	9	4.5	16	12.2	19.8	9.3深8	51	56	71	76	80	85	100	105	61	66	81	86	90	95	110	115
M8×1.25	M5×0.8深8	5.5	12	6	20	15.2	24.8	9.3深9	55	60	75	80	88	93	108	113	65	70	85	90	98	103	118	123
M10×1.25	M6×1.0深9	6.6	13	4.5	24	18.2	30.8	11深11.5	57	62	77	82	99	104	119	124	67	72	87	92	109	114	129	134

自由安装气缸 Free Mount Air Cylinder

Series KCU

外形尺寸图 Dimensions (mm)

KCUK-T 杆不回转型-单动 (弹簧压出)
Non-rotating Type-Single Acting (Spring Extend)

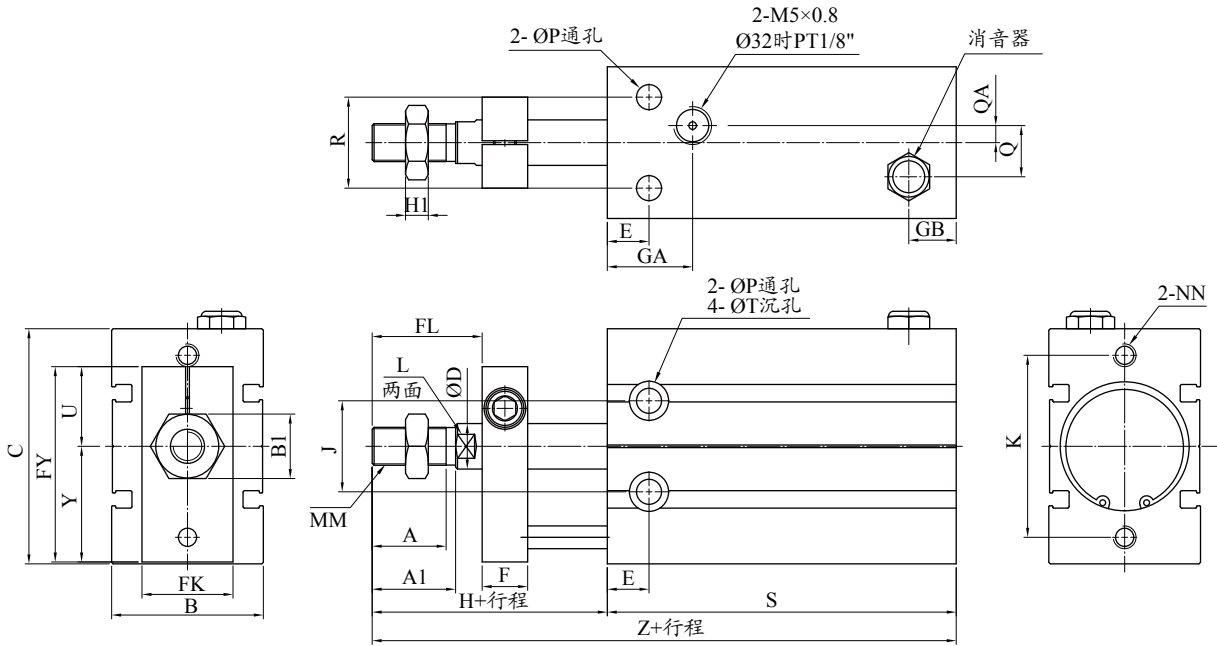

符号 缸径	A	A1	B	B1	C	D	E	F	FL	FK	FY	GA	GB	H	H1	J	K	L
6	7	8	16.5	5.5	22	3	7	8	9	11	19	14	10	18	2.4	10	17	-
10	10	11	16.5	7	24	4	7	8	12	13	20.5	15.5	10	21	2.4	11	18	-
16	11	12.5	20	8	32	6	7	8	17	13	26.5	14.5	10	26	4	14	25	5
20	12	14	26	10	40	8	9	8	20	16	32	19	11	29	5	16	30	6
25	15.5	18	32	12	50	10	10	10	22	19	40	21.5	8.5	33	6	20	38	8
32	19.5	22	40	17	62	12	11	12	29	24	49	23	12.5	42	6	24	48	10

MM	NN	P	Q	QA	R	U	Y	T	无磁环								带磁环							
									S				Z				S				Z			
									5St	10st	15st	20st	5St	10st	15st	20st	5St	10st	15st	20st	5St	10st	15st	20st
M3×0.5	M3×0.5深5	3.2	-	-	7	8.1	10.9	6深5	43	48	58	63	61	66	76	81	43	48	58	63	61	66	76	81
M4×0.7	M3×0.5深5	3.2	-	-	9	8.6	11.9	6深5.6	46	51	61	66	67	72	82	87	46	51	61	66	67	72	82	87
M5×0.8	M4×0.7深5	4.5	3	1.5	12	10.6	15.9	7.6深6.5	45	50	65	70	71	76	91	96	55	60	75	80	81	86	101	106
M6×1.0	M5×0.8深7.5	5.5	9	4.5	16	12.2	19.8	9.3深8	51	56	71	76	80	85	100	105	61	66	81	86	90	95	110	115
M8×1.25	M5×0.8深8	5.5	12	6	20	15.2	24.8	9.3深9	55	60	75	80	88	93	108	113	65	70	85	90	98	103	118	123
M10×1.25	M6×1.0深9	6.6	13	4.5	24	18.2	30.8	11深11.5	57	62	77	82	99	104	119	124	67	72	87	92	109	114	129	134

自由安装气缸 Free Mount Air Cylinder

Series KCU

外形尺寸图 Dimensions (mm)

KCUKW 杆不回转双杆型
(Non-rotating Double Rod)

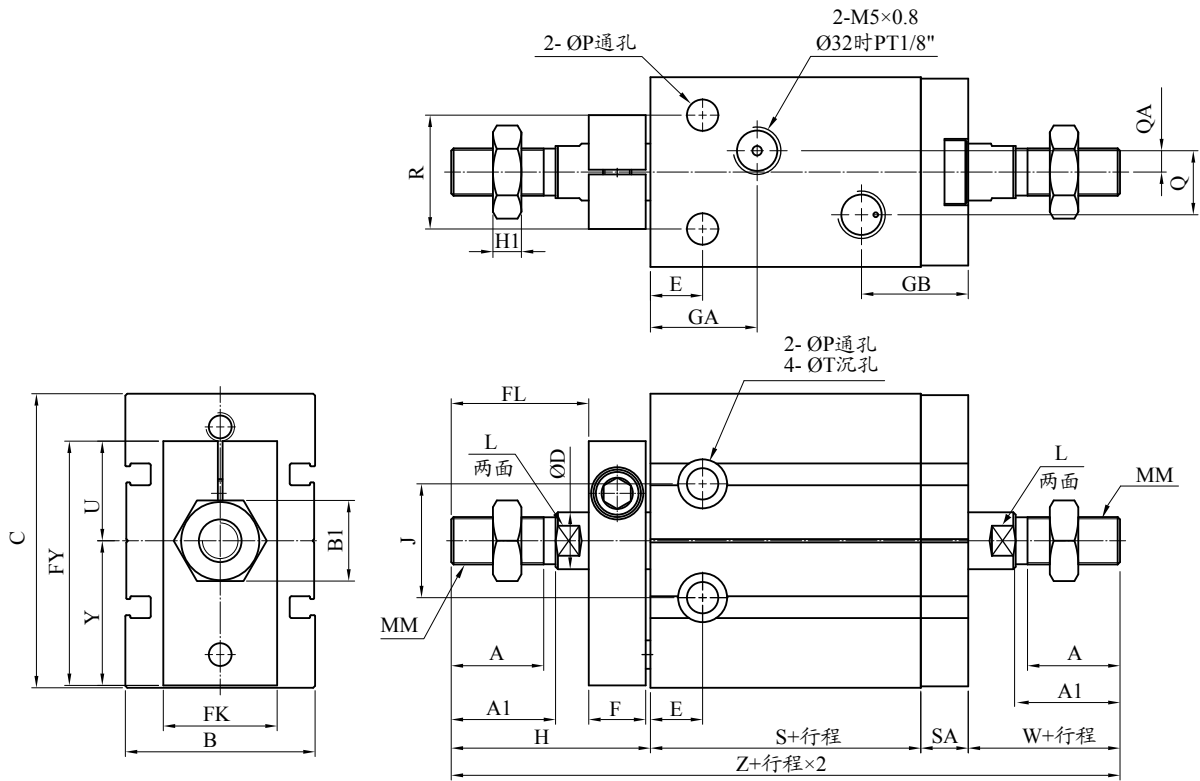

符号 缸径	A	A1	B	B1	C	D	E	F	FL	FK	FY	GA	GB	H	H1	J	L
6	7	8	16.5	5.5	22	3	7	8	9	11	19	14	16	18	2.4	10	-
10	10	11	16.5	7	24	4	7	8	12	13	20.5	15.5	16	21	2.4	11	-
16	11	12.5	20	8	32	6	7	8	17	13	26.5	14.5	17.5	26	4	14	5
20	12	14	26	10	40	8	9	8	20	16	32	19	20	29	5	16	6
25	15.5	18	32	12	50	10	10	10	22	19	40	21.5	17.5	33	6	20	8
32	19.5	22	40	17	62	12	11	12	29	24	49	23	22.5	42	6	24	10

MM	P	Q	QA	R	SA	T	U	W	Y	无磁环		带磁环	
										S	Z	S	Z
M3×0.5	3.2	-	-	7	6	6 深5	8.1	13	10.9	38	75	38	75
M4×0.7	3.2	-	-	9	6	6 深5.6	8.6	16	11.9	36	79	36	79
M5×0.8	4.5	3	1.5	12	7.5	7.6 深6.5	10.6	16	15.9	30	79.5	40	89.5
M6×1.0	5.5	9	4.5	16	9	9.3 深8	12.2	19	19.8	36	93	46	103
M8×1.25	5.5	12	6	20	9	9.3 深9	15.2	23	24.8	40	105	50	115
M10×1.25	6.6	13	4.5	24	10	11 深11.5	18.2	27	30.8	42	121	52	131

自由安装气缸 Free Mount Air Cylinder

Series KCU

外形尺寸图 Dimensions (mm)

KCUK-ST 杆不回转型-可调行程
(Non-rotating Type -Adjustable Stroke)

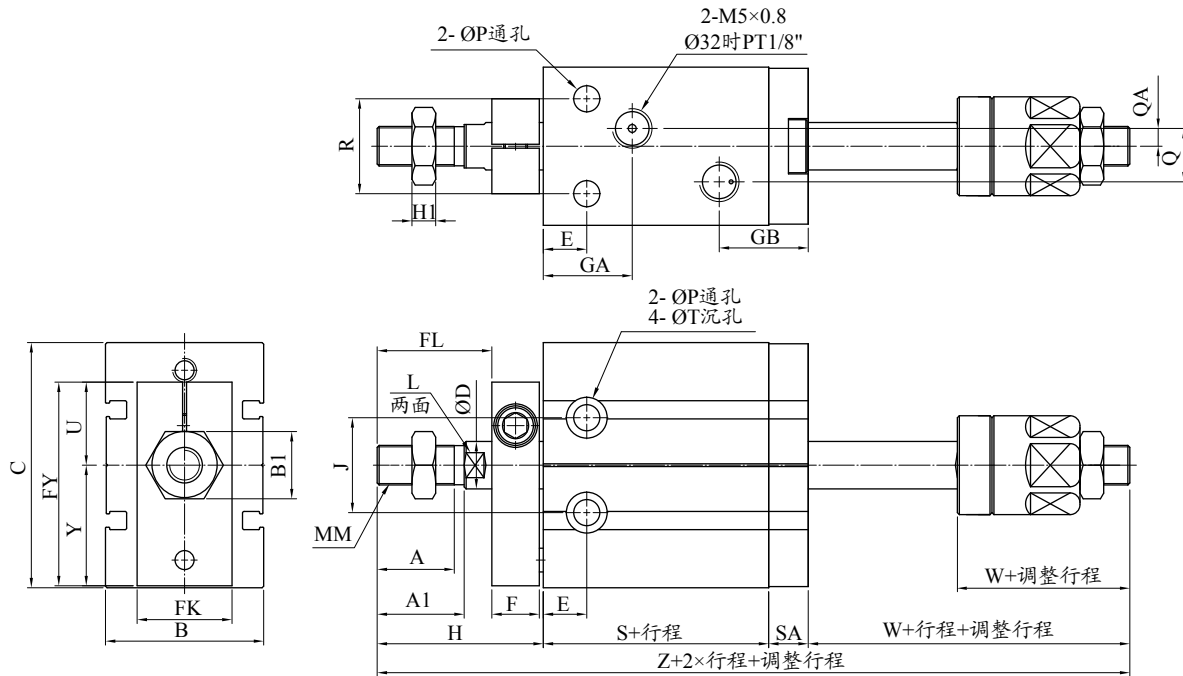

符号 缸径	A	A1	B	B1	C	D	E	F	FL	FK	FY	GA	GB	H	H1	J	L
6	7	8	16.5	5.5	22	3	7	8	9	11	19	14	16	18	2.4	10	-
10	10	11	16.5	7	24	4	7	8	12	13	20.5	15.5	16	21	2.4	11	-
16	11	12.5	20	8	32	6	7	8	17	13	26.5	14.5	17.5	26	4	14	5
20	12	14	26	10	40	8	9	8	20	16	32	19	20	29	5	16	6
25	15.5	18	32	12	50	10	10	10	22	19	40	21.5	17.5	33	6	20	8
32	19.5	22	40	17	62	12	11	12	29	24	49	23	22.5	42	6	24	10

MM	P	Q	QA	R	SA	T	U	W	Y	无磁环		带磁环	
										S	Z	S	Z
M3×0.5	3.2	-	-	7	6	6 深5	8.1	13	10.9	38	75	38	75
M4×0.7	3.2	-	-	9	6	6 深5.6	8.6	14.7	11.9	36	77.7	36	77.7
M5×0.8	4.5	3	1.5	12	7.5	7.6 深6.5	10.6	17	15.9	30	80.5	40	90.5
M6×1.0	5.5	9	4.5	16	9	9.3 深8	12.2	21	19.8	36	95	46	105
M8×1.25	5.5	12	6	20	9	9.3 深9	15.2	25	24.8	40	107	50	117
M10×1.25	6.6	13	4.5	24	10	11 深11.5	18.2	27	30.8	42	121	52	131